

Note: Instructions below show assembly of desk high tambour, use same methods and steps for taller units.

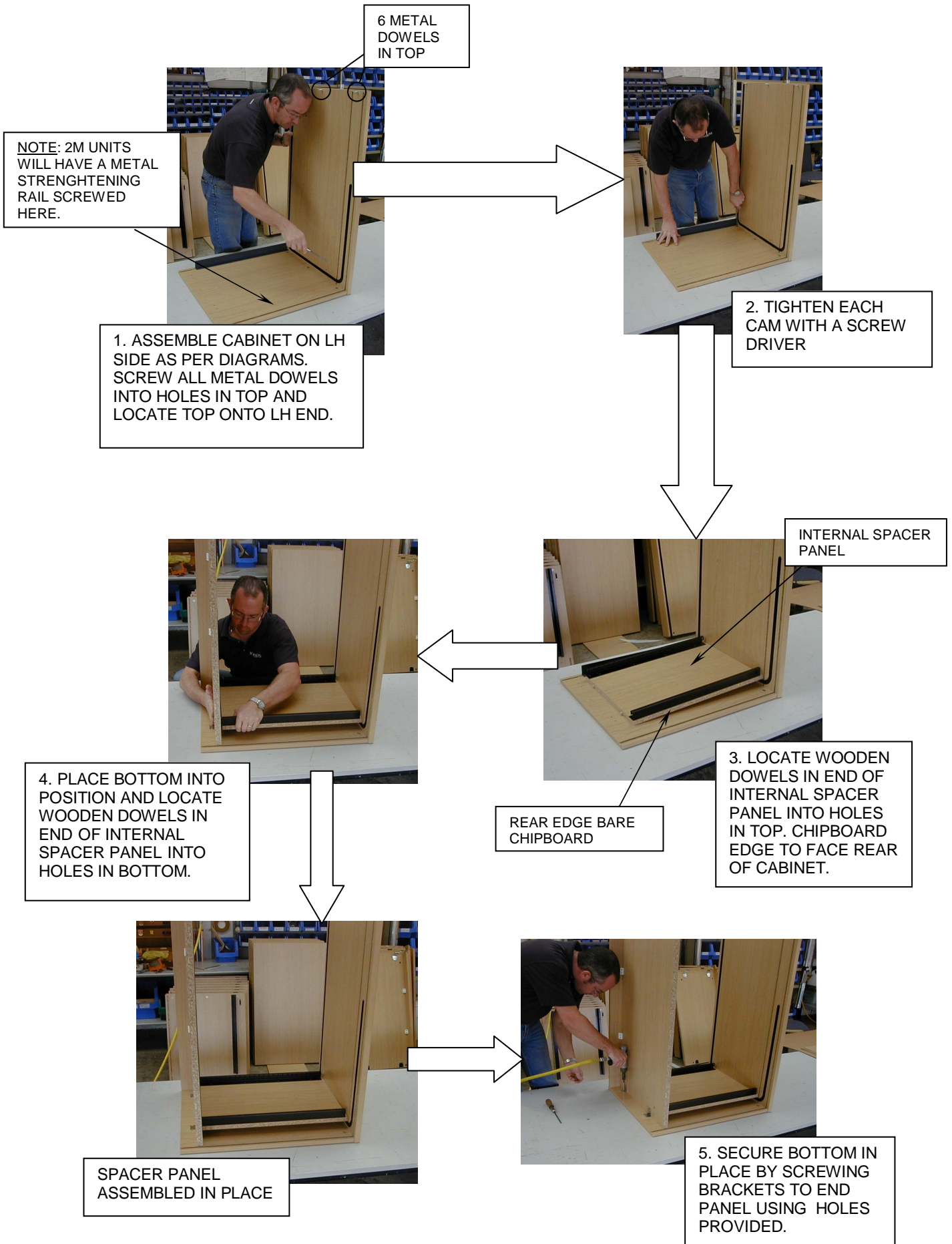

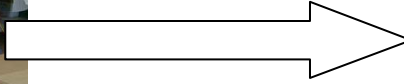

6. SLIDE INTERNAL BACK PANEL INTO INNER GROOVES.



7. SECURE INNER BACK PANEL TO BACK EDGE OF INTERNAL SPACER PANEL WITH SCREWS PROVIDED.



9. PLACE RIGHT HAND END ONTO CONSTRUCTION LOCATING METAL DOWELS IN TOP INTO HOLES IN END OF RH PANEL. TIGHTEN CAMS ON INSIDE FACE OF RH END.

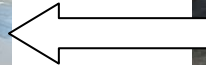

8. SLIDE TAMBOUR INTO PLASTIC CHANNEL.

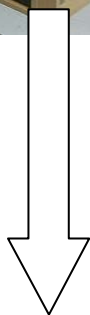

10. TIGHTEN CAM ON REAR OF CABINET



11. SCREW BOTTOM
TO RH END USING
BRACKETS AND
HOLES PROVIDED.

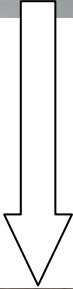

12. SLIDE BACK
PANEL INTO
GROOVE IN BACK OF
CABINET.

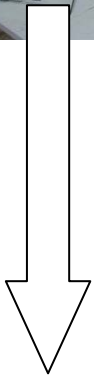

13. SCREW BACK PANEL TO
EDGE OF BOTTOM PANEL
USING HOLES PROVIDED.

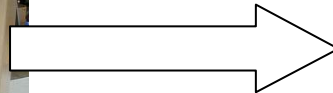

14. YOUR CABINET CAN NOW
BE UPTURNED INTO ITS
CORRECT POSITION.